

Bridge will undertake landscaping works to help soften the appearance of the building and add visual interest to the wider area. The proposed works will be a significant improvement on the existing situation.

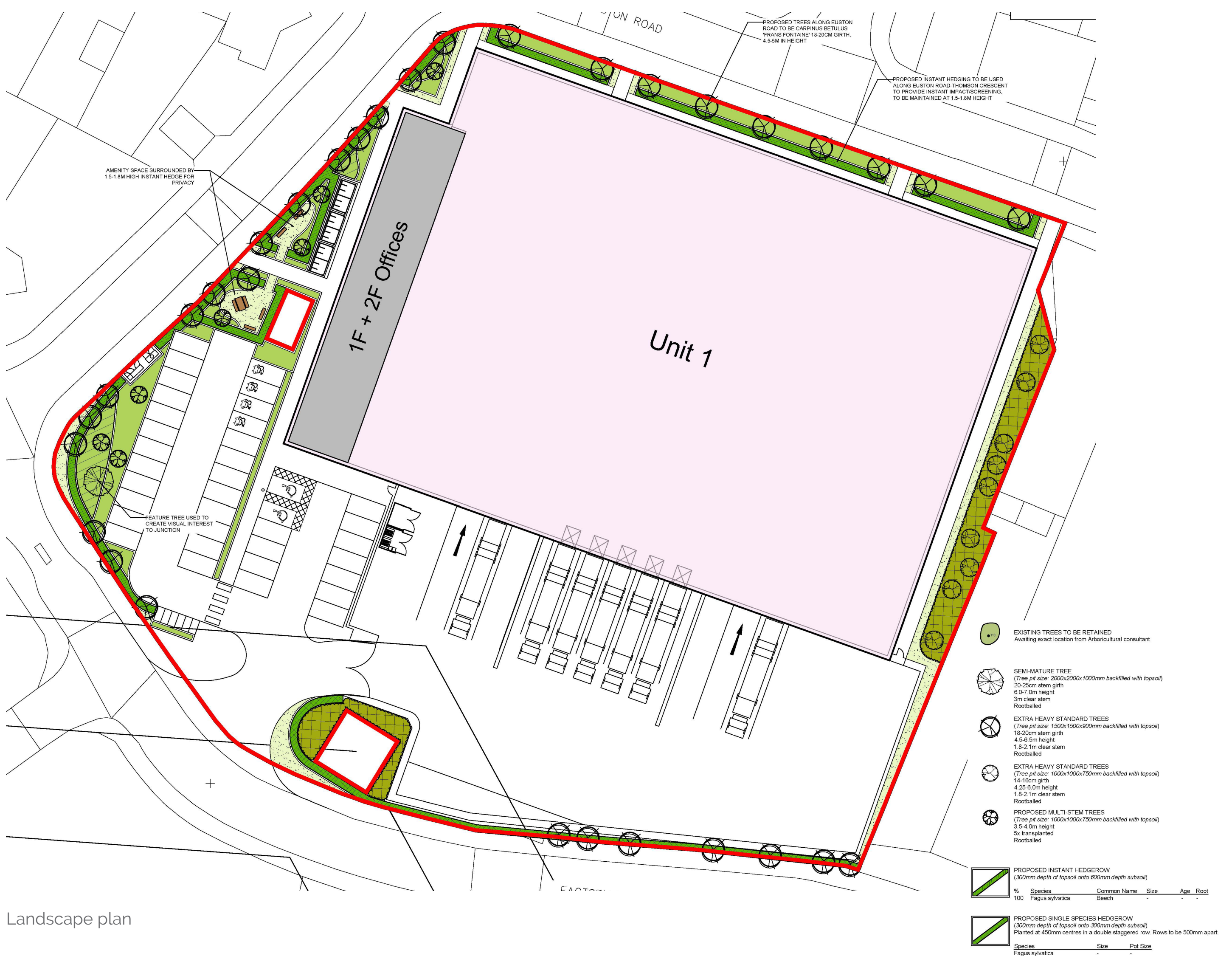

Landscape plan

Landscaping works will include:

- Planting of new native trees and shrubs around the perimeter of the site;
- This will help soften the view of the building from Euston Road, Roman Way and Factory Lane;
- Planting will include a mix of semi-mature native trees, extra heavy standard trees and native shrubs;
- A feature tree facing out towards the Factory Lane and Roman Way junction;
- An improvement on the existing biodiversity situation.